

Insulated Washer

- Nominal dimensions are indicated. Inner diameter is clearance for screw size shown. Others are +/- 1/64"
- Alternative sizes, materials, or finishes may be obtained in quantity as special order
- Nylon washers are Type 6/6, offered in natural milky white color
- Fiber washers are commercial grade black galvanized fiber

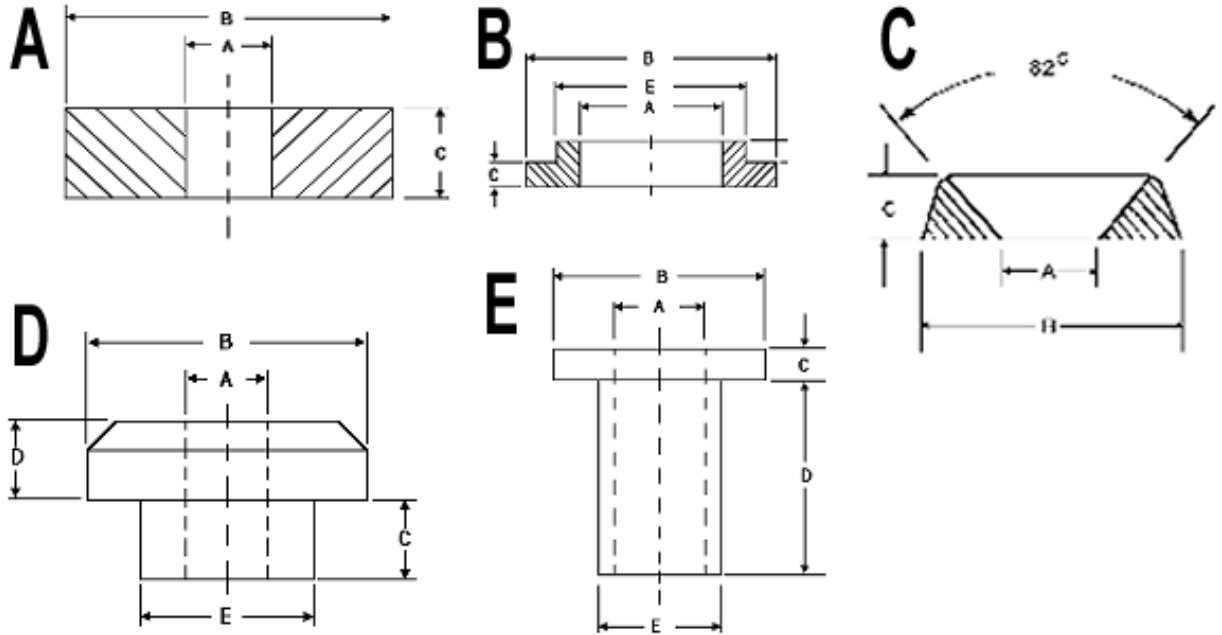

PART NO.	FIG.	SCREW CLEAR	MAT.	ID	OD	THNKS C	HT. D	DIA. E					
				A	B								
2191	A	#2	FIBRE	3/32	1/4	1/32	1/32	-					
2652			NYLON			1/16	1/16						
2671		#4	FIBRE	1/8	9/32	3/64	3/64						
2514					NYLON	1/4	1/16		1/16				
2161		#6	FIBRE	9/64	3/8	1/16	1/16						
2160					NYLON				1/4	3/64	3/64		
2162		#8	FIBRE	11/64	5/16	3/8	1/16		1/16				
2670					NYLON					1/4	3/64	3/64	
2515		#10	FIBRE	13/64	5/8	1/2	3/32		3/32				
2672					NYLON					1/4	3/32	3/32	
2673		1/4	FIBRE	1/4	1/2	3/32	3/32						
2163									NYLON	1/4	3/32	3/32	
2164		5/16	FIBRE	5/16	5/16	5/16	5/16						
2674									NYLON	5/16	5/16	5/16	
2518		5/16	FIBRE	5/16	5/16	5/16	5/16		5/16				
2675										NYLON	5/16	5/16	5/16
2676										FIBRE	5/16	5/16	5/16
2166										NYLON	5/16	5/16	5/16
2165										FIBRE	5/16	5/16	5/16
2167		5/16	FIBRE	5/16	5/16	5/16	5/16		5/16				
2677	NYLON							5/16		5/16	5/16		

- Home
- About Abbatron
- Products
- Locate Distributor or Representative
- Contact Us
- Request Information
- Site Map

- Inventory Search
- Cross Reference
- UPS Tracking

632 Arch Street, POB
726 Meadville, PA
16335 USA 814-724-
6440 [Contact Webmaster](#)
© May 6, 2005

2166											
2165			FIBRE		1/2						
2167											
2677		5/16		5/16							
2679			NYLON		3/4		1/16	1/16			
2678		3/8		3/8	5/8						
2168			FIBRE		3/4						
2169											
2517		#10	NYLON	13/64	7/16						
2651	B	#2		3/32	1/4	.055	.025	5/32			
2171			FIBRE								
2151		#4		1/8	17/64	1/16					
2661			NYLON		9/64	1/4	1/32	3/16			
2662		#6				5/16	3/32				
2663											
2660	B	#6	NYLON		3/8	3/32	1/32	1/4			
2152					9/64			1/4	3/16		
2153				FIBRE				5/16			
2150					3/8					1/4	
2155		#8		11/64	3/8						
2665			NYLON								
2666		#10		13/64							
2156			FIBRE							5/16	
2154		1/4		1/4				1/2			
2664			NYLON								
2669		17/64		17/64						3/8	
2159											
2158		3/8		FIBRE				5/8			
2157					3/8			3/4			1/2
2668									5/8		
2667						3/4	1/16				
2687	C	#6		9/64	7/16		3/32				
2688		#8		11/64	33/64	7/64	7/64				
2689		#10		13/64	37/64	9/64	9/64	-			
2690				15/64	39/64	5/32	5/32				
2691		1/4"		1/4	43/64	3/16	3/16				
2681	D	#4		1/8	9/32	.040	.040	3/16			
2682		#6	NYLON	9/64	21/64			7/32			
2683		#8		11/64	3/8			1/4			
2684		#10		13/64	7/16	.050	.050	9/32			
2685		1/4		1/4	9/16	.060	.060	3/8			
2686		3/8		3/8	3/4			1/2			
2534	E	#4		7/64	15/64	3/64	1/4	9/64			
2535		#6		9/64	19/64			11/64			
2536		#8		11/64	11/32			13/64			
2537		#10		13/64	13/32	1/16	3/8	17/64			
2538		1/4		17/64	13/64			5/16			